

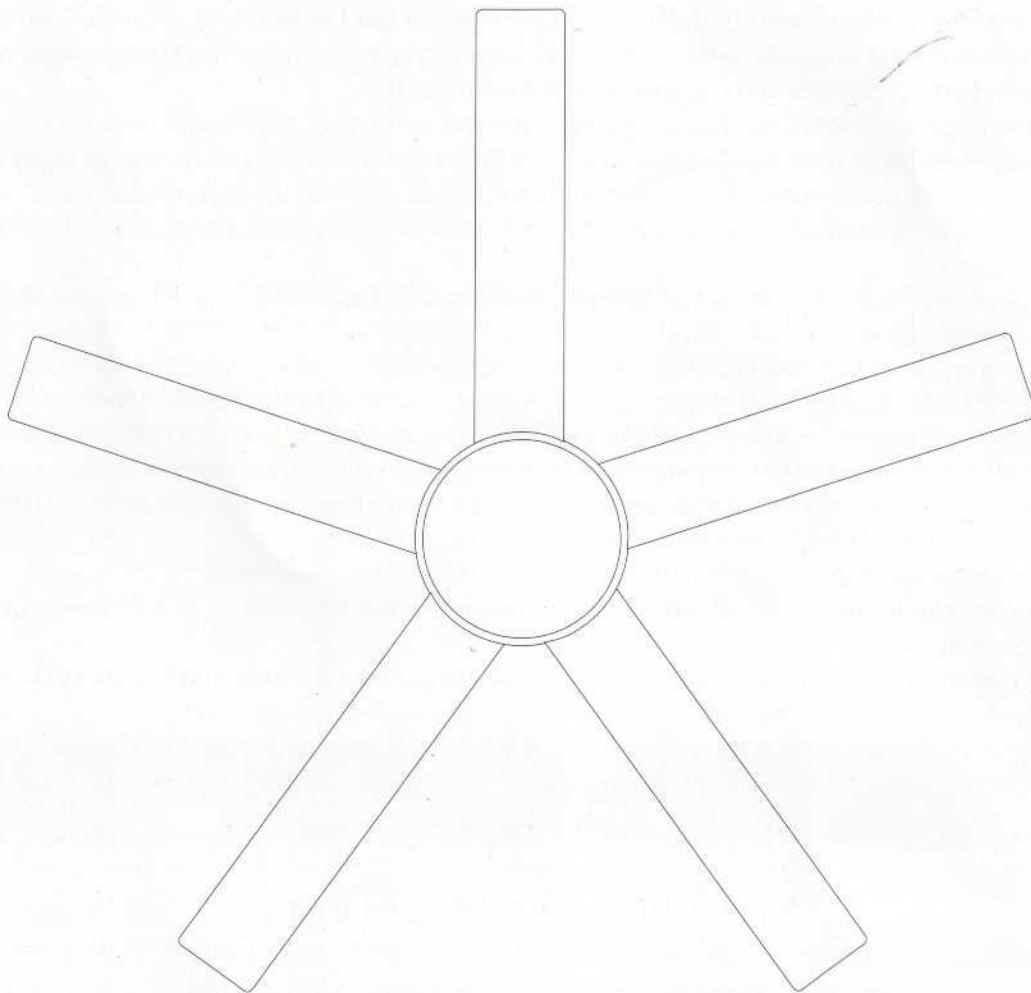

# Smart WiFi Indoor Ceiling Fan

AT2482



## Let's get started!

Quick Start Guide

# FOR YOUR SAFETY

READ AND SAVE ALL INSTRUCTIONS BEFORE USING.

## WARNING

1. To reduce the risk of personal injury, do not bend the blade brackets when installing the brackets, balancing the blades, or cleaning the fan. Do not insert foreign objects in between rotating fan blades.
2. To reduce the risk of fire, electric shock, or personal injury, mount directly to a structural framing member or to an outlet box marked "acceptable for fan support of 31.8kg (70lb) or less". For outlet box mounting, use mounting screws provided with the outlet box.
3. The fan can be mounted to a structural framing member or an outlet box. When mounted to an outlet box, use the screws provided with the outlet box.
4. The installation is in accordance with the National Electrical Code, ANSI/NFPA 70, and local codes.
5. To avoid possible electrical shock, before installing or servicing your fan, disconnect the power by turning off the circuit breaker to the outlet box and associated wall switch location.
6. To reduce the risk of electric shock, this fan must be installed with an isolating wall control/switch.
7. The wall switch used shall have been investigated and found acceptable for use as a general-use switch.
8. After making the wire connections, the wires should be spread apart with the grounded conductor and the equipment-grounding conductor on one side of the outlet box and the ungrounded conductor on the other side of the outlet box.
9. After the splices are made, they should be turned upward and pushed carefully up into the outlet box.
10. A grounded conductor is to be connected to a grounded conductor of power supply, a conductor of fan identified as ungrounded conductor is to be connected to an ungrounded conductor of power supply, and a conductor of fan identified for equipment grounding is to be connected to an equipment-grounding conductor.
11. To reduce the risk of electric shock, disconnect the electrical supply circuit to the fan before installing the light kit.
12. This appliance is not intended for use by persons (including children) with reduced physical, sensory, or mental capabilities, or lack of experience and knowledge unless they have been given supervision or instruction concerning use of the appliance by a person responsible for their safety.
13. Children should be supervised to ensure that they do not play with the appliance.
14. To avoid any accidental losses, all set screws must be checked and retightened, where necessary, before installation.
15. Before installation, check that the outlet box is securely installed in place such that it is able to support at least the fan weight (total weight: 17.01lb.).

**Caution:** Modifications not approved by the party responsible for compliance could void user's authority to operate the equipment.

## Mounting to high ceilings?

Maximize your comfort by choosing the right accessory downrod length for your ceiling.

If you have an angled ceiling, you may need a longer downrod.

### Know your ceiling height

4in. and 12in. rod included >>> Ideal for 9ft. to 11ft. ceiling height

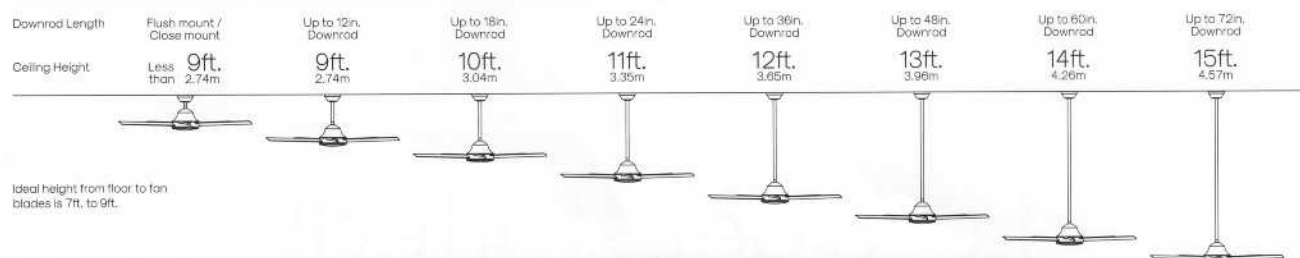

Visit [www.atomismart.com](http://www.atomismart.com) to find additional downrod options.

# WHAT'S IN THE BOX

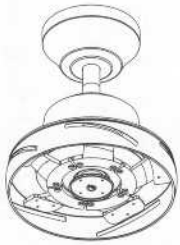

Ceiling Fan



Fan Blade (x5)



12" Downrod

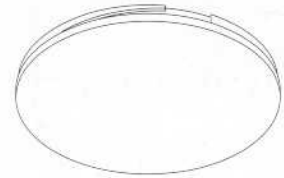

Acrylic Shade

## Light Fixture

This fixture comes pre-assembled.  
Please, check step 1 on page 15 for instructions.

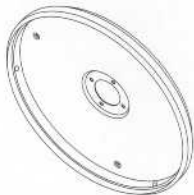

Light Ring



LED Board + LED Board Cover

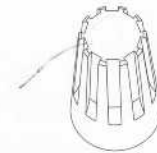

Bag D  
Wire Nut (x3)

## Mounting Bracket Accessory

Bag B1

Bag B2

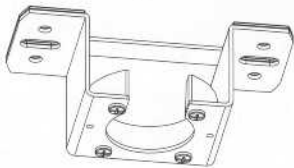

Standard  
Mounting Bracket



Wood Screw (x2)  
Washer (x2)

## Blades Accessory Bag

Bag A1

Bag A2



Blade  
Screw (x17)



Clip



Balance  
Weight (x5)

## Remote Control Accessory Bag

Bag E1

Bag E2

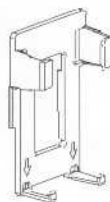
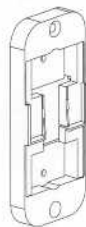

Remote Control  
Remote Control Bracket



Remote Control  
Mount Screw (x2)



Remote Control  
Mount Anchor (x2)

3M

Sticker (x2)



## TOOLS NEEDED FOR INSTALLATION

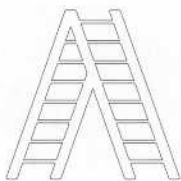

Ladder



Screwdriver



Wire strippers  
(If applicable)

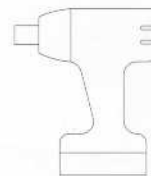

Drill

(If mounting to a support structure or concrete. Only concrete-compatible screws are included.)

## SELECT YOUR INSTALLATION LOCATION

Measure room dimensions

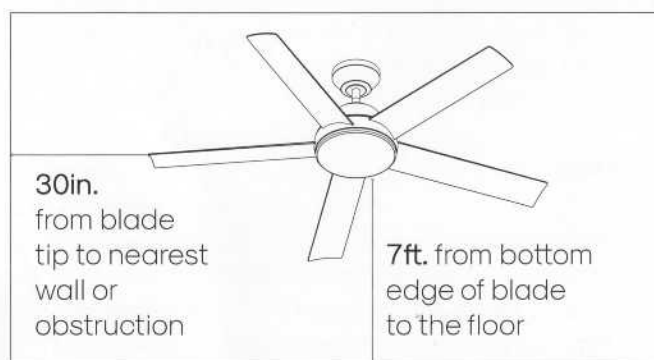

Check the outlet box

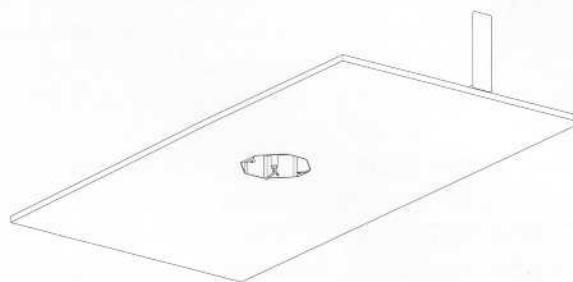

The fan must be secured to a fan-rated outlet box capable of supporting 31.8kg (70lb).

4

## CEILING FAN MOUNTING OPTIONS

Unpack and inspect the fan carefully to confirm that all parts are included.

### Flush Mounting

**Pre-assembled.** The Atom Smart Ceiling Fan comes already prepped for this installation option.

Ceiling Outlet Box

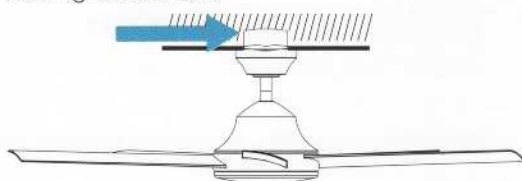

### Standard Mounting

Ceiling Outlet Box

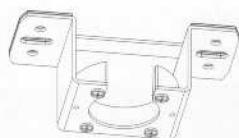
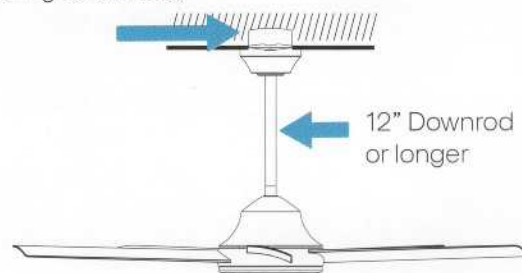

Standard bracket maximum angle =  
20 degrees

## Other Mounting Options

If there isn't an existing UL (cUL for Canadian Installation) listed mounting box, then read the following instructions.

- Disconnect the power by removing fuses or turning off circuit breakers.
- Secure the outlet box directly to the building structure. Use appropriate fasteners and building materials.
- The outlet box and its support must be able to fully support the moving weight of the fan (31.8kg or 70lb). Do not use plastic outlet boxes.

Figures 1, 2 and 3 are examples of different ways to mount the outlet box.



ATTENTION

If you are installing the ceiling fan on a sloped (vaulted) ceiling, you may need a longer downrod to maintain proper clearance between the tip of the blade and the ceiling. A minimum clearance of 12in. is suggested for optimal operation.



ATTENTION

Depending on the location selected for installation, you may need to purchase and install a "Joist Hanger" for the support of the outlet box. Make sure the joist hanger you purchase has been designed for use with ceiling fans. (Fig. 4)

1

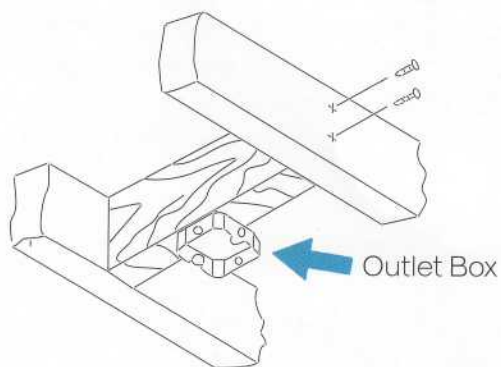

2

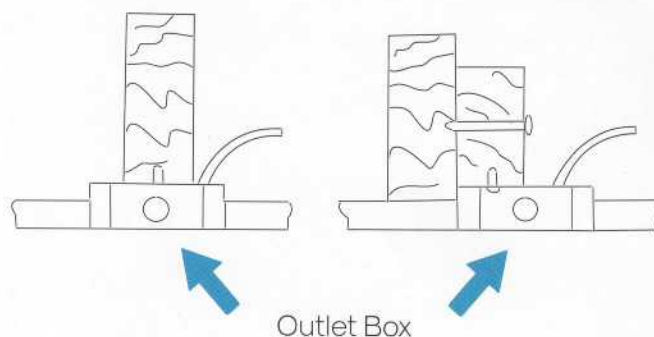

3

Angled ceiling maximum 20° angle

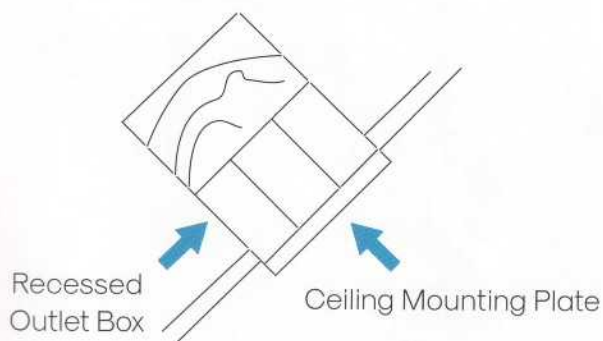

4

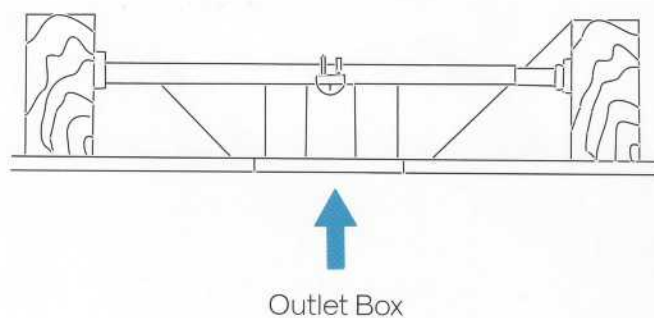

If your outlet box is not mounted or if you do not have proper wiring in your outlet box, hire an electrician. You will need a hot (black), neutral (white), and ground (green or bare copper) to operate this fan.

BAG  
B1

1

## INSTALLING THE STANDARD BRACKET



**PREVENT POSSIBLE ELECTRIC SHOCK.** Before installing your fan, disconnect the power by turning off the circuit breakers to the outlet box associated with the wall switch location.

Only use the provided Atomi Smart ceiling bracket that comes with your fan.

Remove any existing brackets from your ceiling prior to installation.

Secure the bracket to a ceiling box that is acceptable for fan support of 31.8kg (70lb).

There are two options for the bracket installation so please choose which option works best for your location. Use option 1 for standard ceiling installation using a fan-rated outlet box.

### Option 1: Machine Screws

Use machine screws (provided with your outlet box) and washers when securing to existing ceiling fan-rated outlet box.

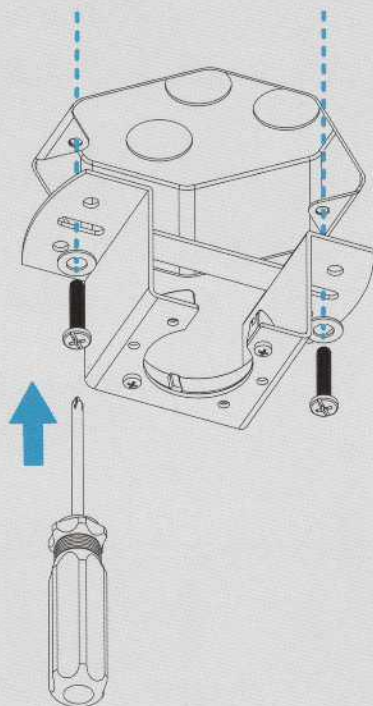

### Option 2: Wood Screws

Use wood screws and washers (included in Bag B2) when securing to support structure with approved electrical outlet box. Drill 9/64" pilot holes in support structure to aid in securing the ceiling bracket.

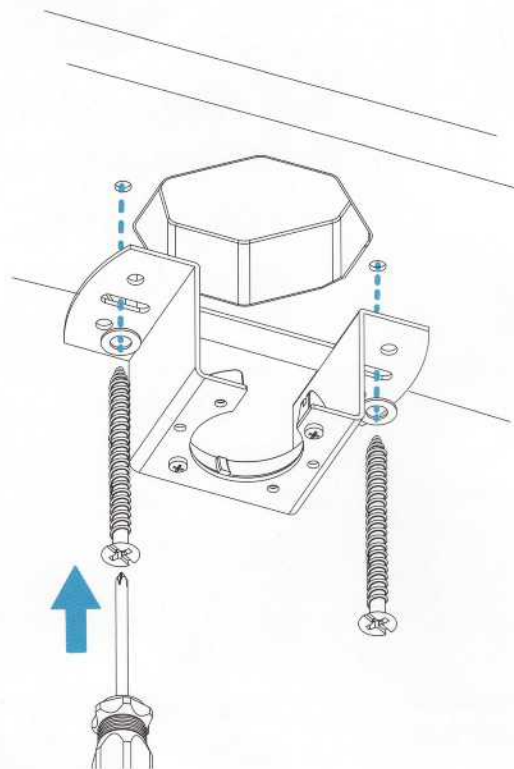

Standard bracket maximum angle =  
20 degrees

Up to 20°



2

12in. DOWNROD



## REPLACING THE DOWNROD (OPTIONAL)

This step is for **Standard** and **Angled Mounting** only.

For the **Flush Mounting** (pre-assembled) please go to Step 4.

If you have a longer downrod from Atomi Smart, please, follow the same instructions.



WARNING

### PREVENT FAN FALLING INJURY OR DEATH:

- ALWAYS tighten screws with a screwdriver or a drill.
- DO NOT hand-tighten screws.
- CHECK that the screws are tight using screwdrivers each time you change fan direction.



## Standard or Angled Mounting

1

Lift the canopy and funnel.

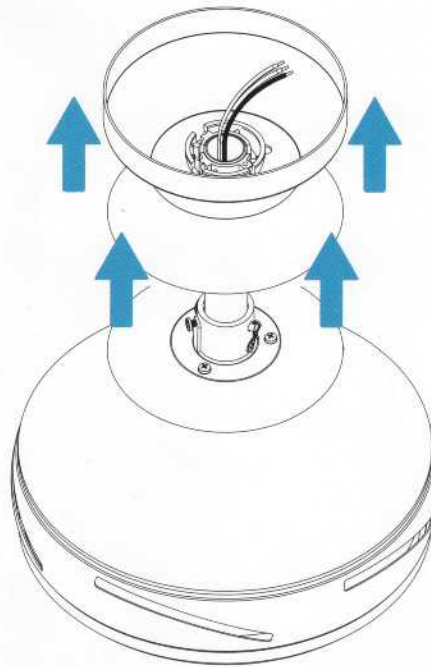

2

Locate and remove the clip and pin.

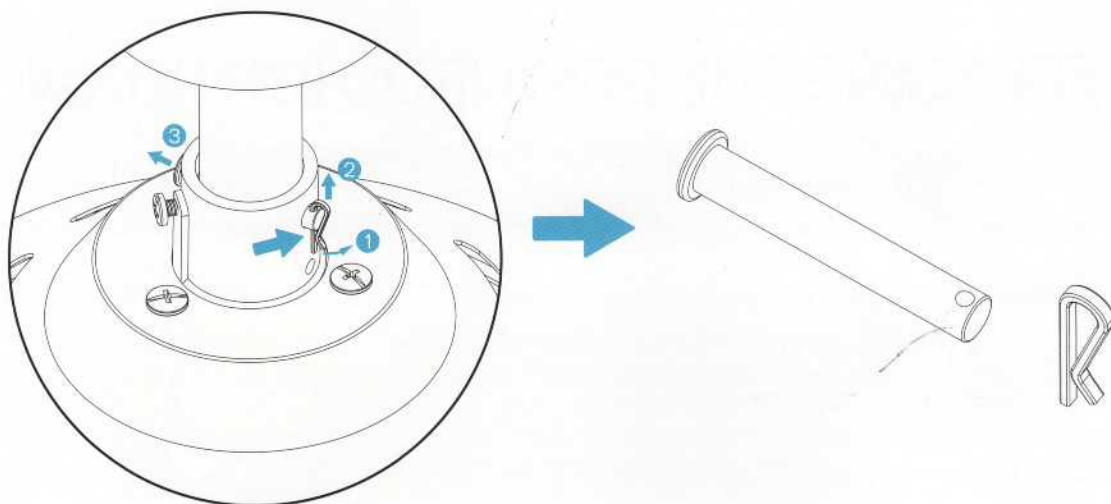

3

Loosen the screws and remove the downrod, canopy, and funnel.

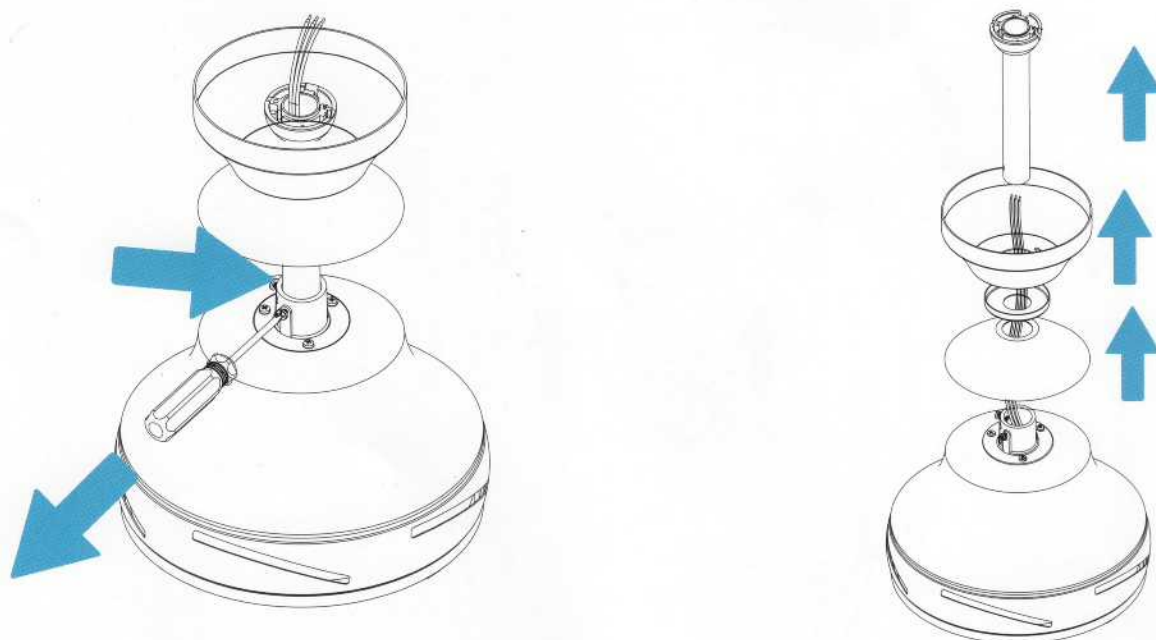



4

Remove the clip and pin from the new downrod.

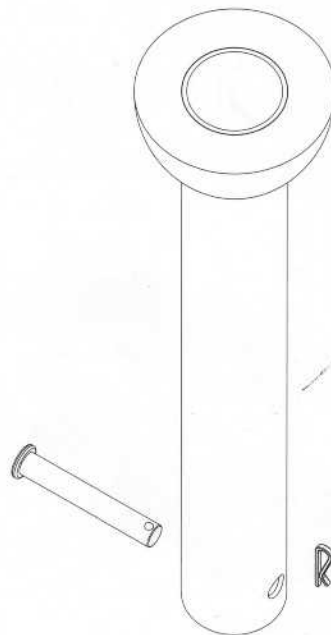
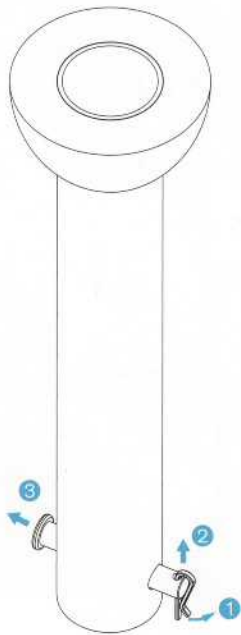

5

Insert the canopy and funnel into the downrod, passing all wires through the downrod.

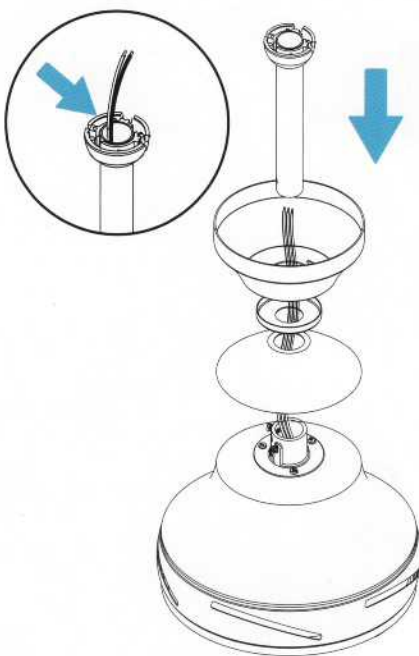

6

Hold the canopy and funnel up to insert the pin and clip back in place.

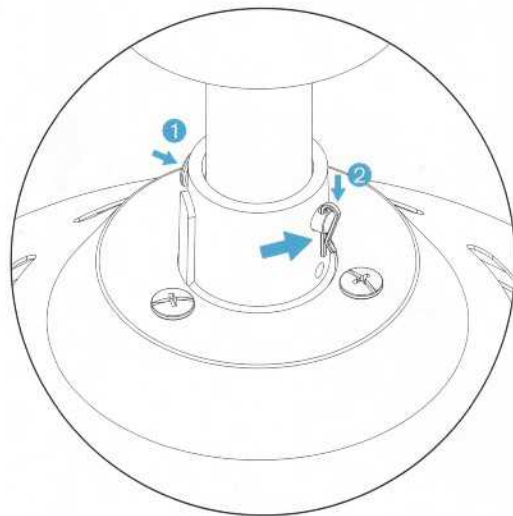

7

Tighten the screws.

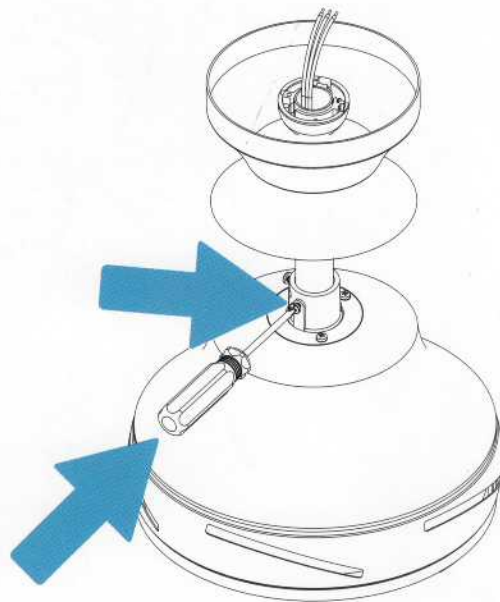

8

Slide down the funnel.

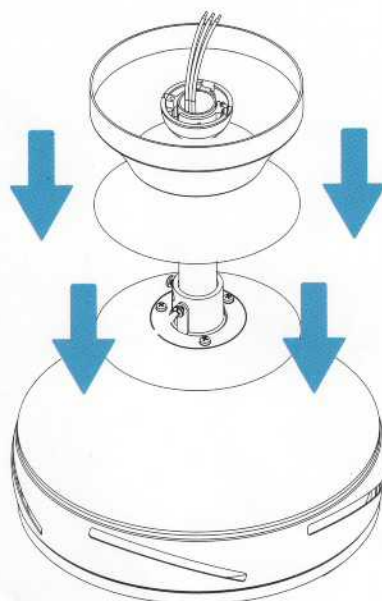

3.

## HANGING THE FAN

Lift and carefully hang the fan on the mounting bracket.



Be sure that the wires are not pinched between the bracket and fan.

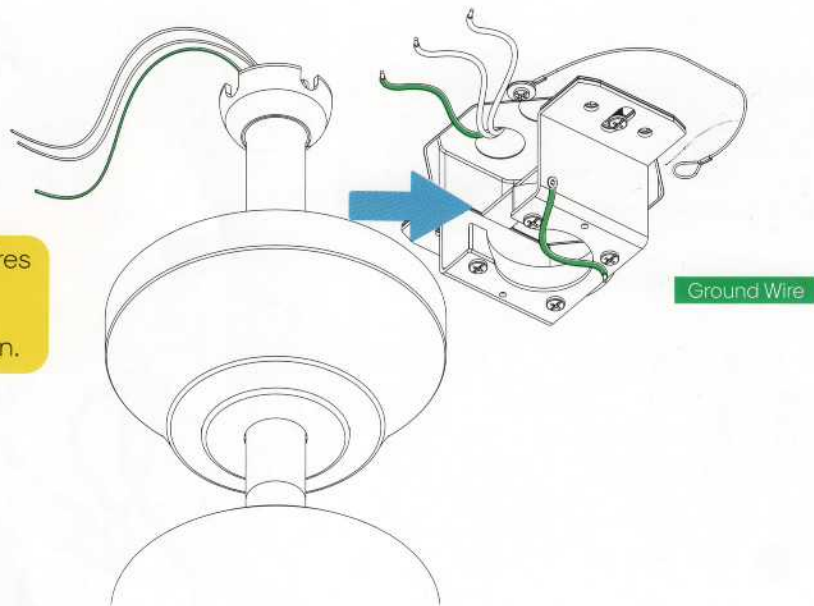

Note: Make sure the downrod is locked and secured to the groove inside the mounting bracket.

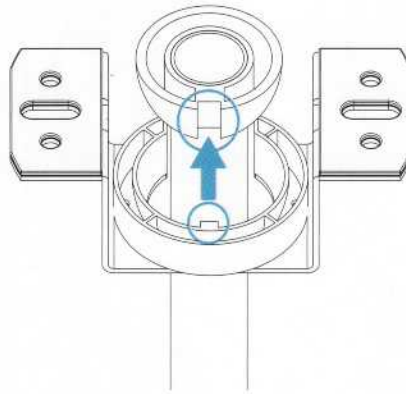



BAG  
D

4

## WIRING THE FAN

Carefully follow these steps to get your fan wired safely and quickly.

If you are unfamiliar with wiring or uncomfortable doing it yourself, please contact a qualified electrician.



WARNING

### THE CEILING FAN MUST BE GROUNDED.

If the ground wire for the installation site is not present or you're unsure what this means, immediately **STOP** installation and consult a qualified electrician.



WARNING

**WIRING MUST BE UP TO CODE.** All wiring must be in accordance with national and local electrical codes. If you are unfamiliar with wiring or in doubt, consult a qualified electrician.

Push the bare metal ends of the wires together and slide a wire nut over them. Twist the wire nut clockwise until tight.

Give it a gentle pull to ensure none of the wires come apart.

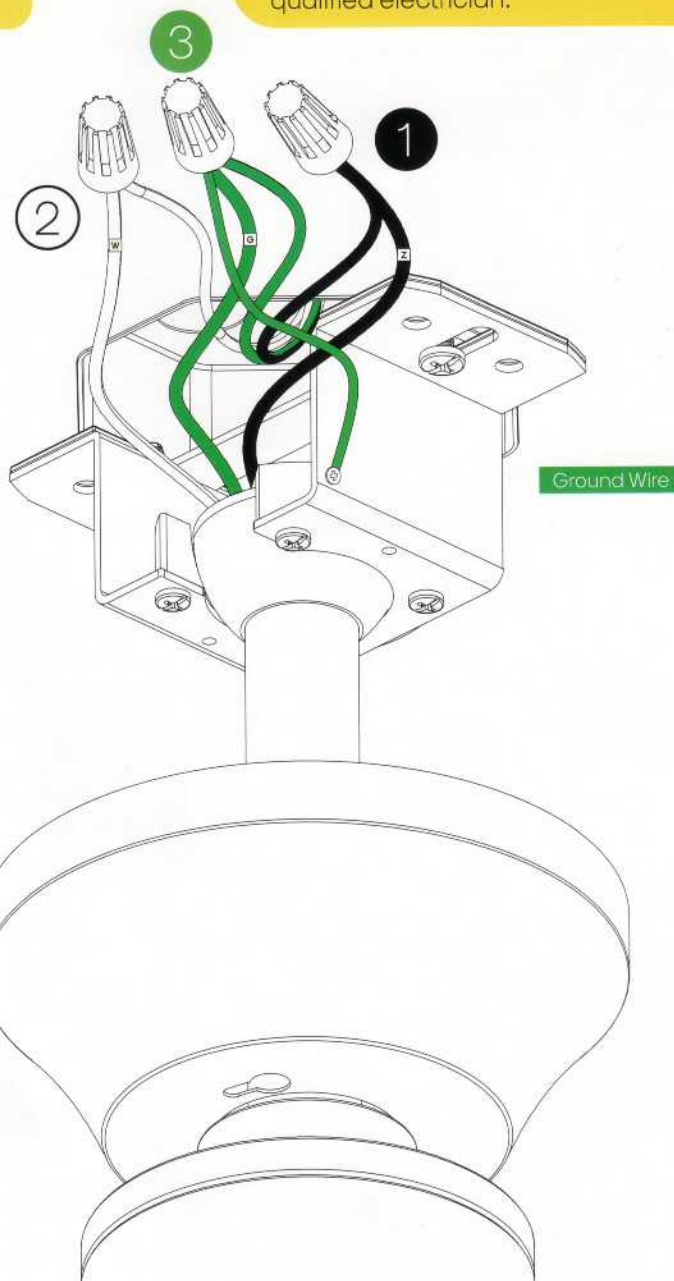

12

1

Connect the **BLACK** (ungrounded Z) wire from the **FAN** to the **BLACK** wire from the **CEILING**.

2

Connect the **WHITE** (W) wire from the **FAN** to the **WHITE** wire from the **CEILING**.

3

Connect the **GREEN** (grounded G) wires from the **FAN** and **BRACKET** to the **GREEN OR BARE** wire from the **CEILING**.



5

## INSTALLING THE CANOPY

1

Lift the canopy into place so that the screw holes are aligned with the housing holes. Insert the screws and loosely secure them. Fit the canopy in place as shown and turn it counter-clockwise.

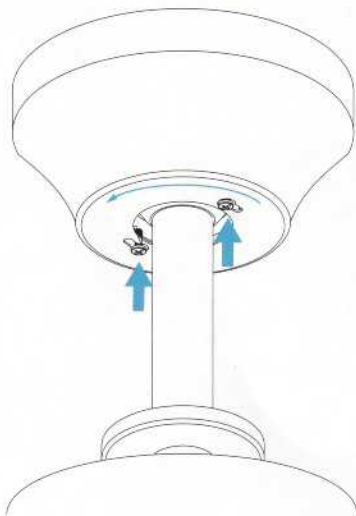

2

Tighten the screws.

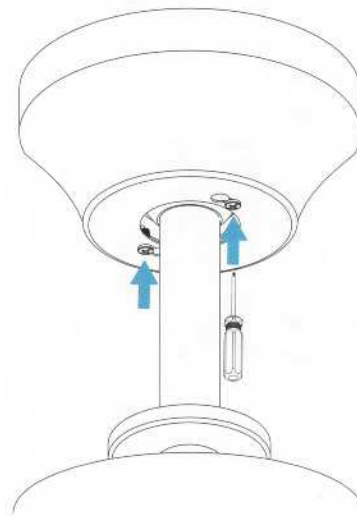

3

Lift the cover plate and turn it clockwise to attach it to the canopy.

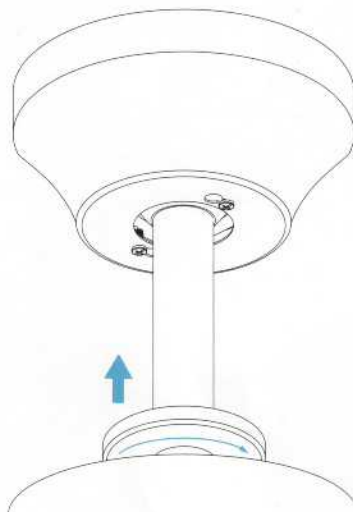

BAG  
A1



6

## INSTALLING THE BLADES

Place each fan blade on the face of the motor plate one at a time.  
Secure each blade with screws found in Bag A1.

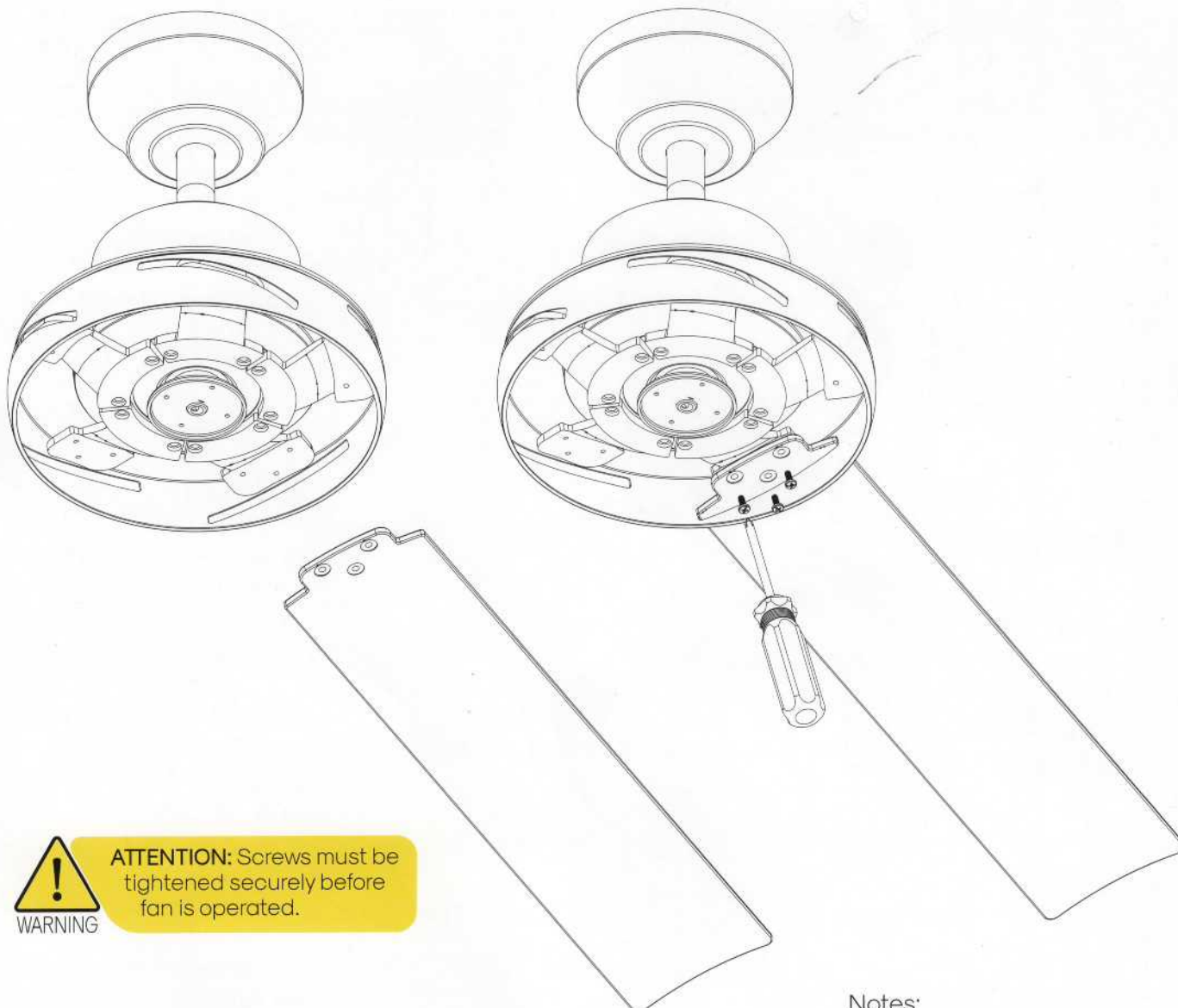

WARNING

**ATTENTION:** Screws must be tightened securely before fan is operated.

### Notes:

- Do not install the fan blades behind the motor plate.
- Ensure proper orientation by looking for "THIS SIDE UP" on fan blades.





7

## ASSEMBLING THE LIGHT FIXTURE

1

Using a screwdriver detach the three parts that come together:  
the light ring, the LED board, and the LED board cover.

Note: Save these screws to be used in step 4.

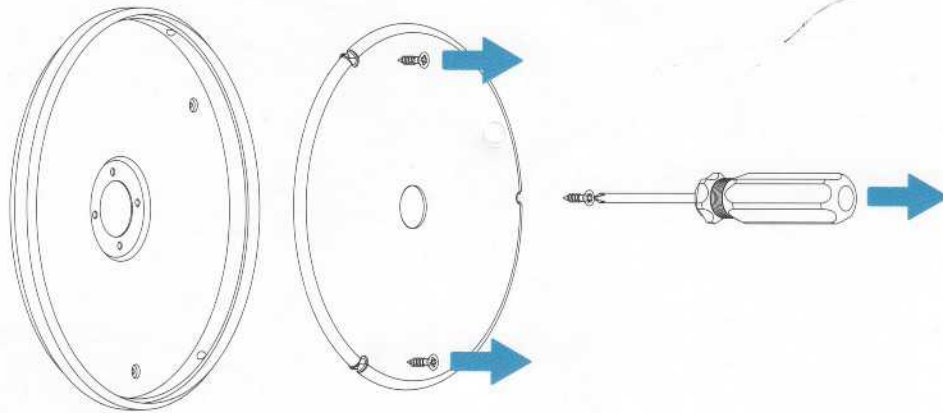

2

Remove the four screws from the fan.

Attach the light ring to the fan by  
tightening the four screws securely.  
Make sure to pass the white connector wire  
through the center hole of the light ring.

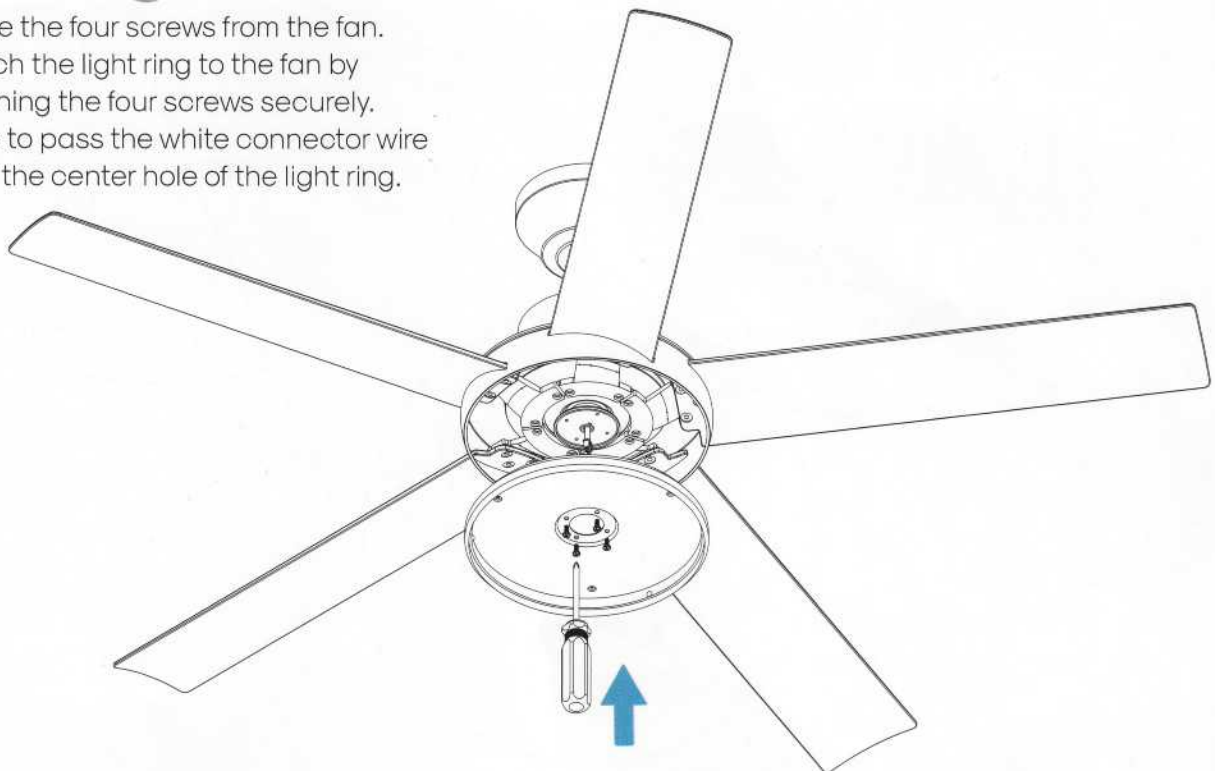

3

Pass the white connector through the center hole of the LED board and cover. Connect the white plug from the housing structure to the white plug from the LED board and cover.

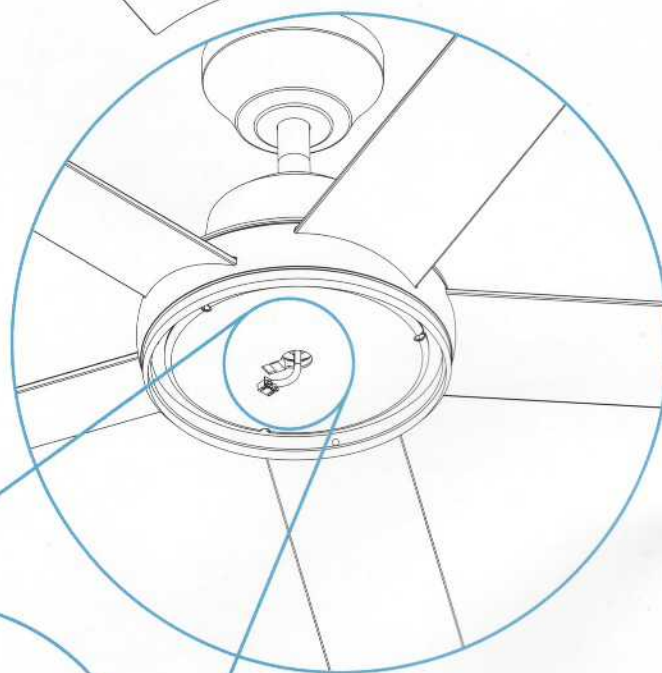
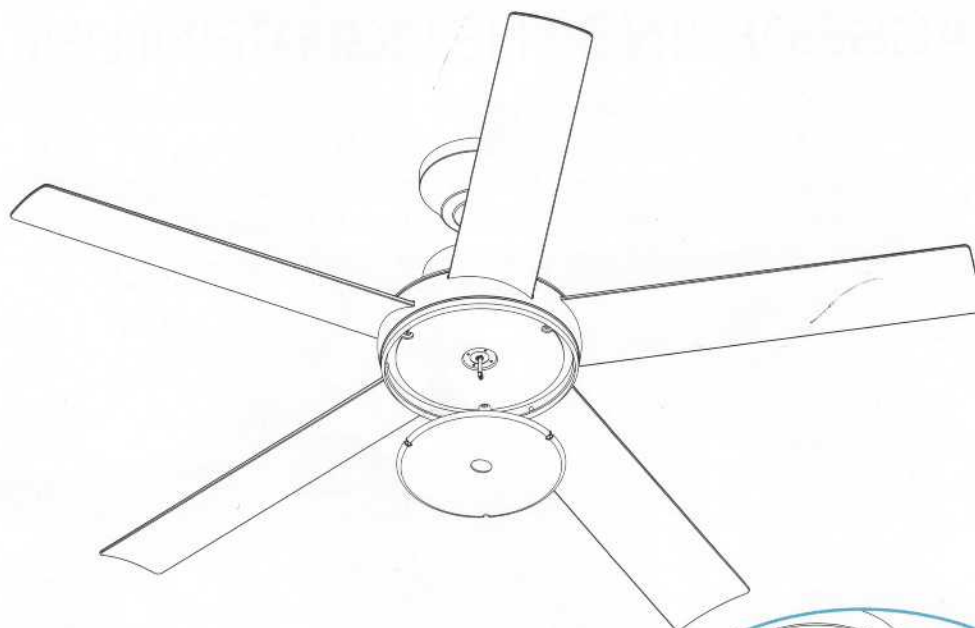

WARNING

Do not press the LEDs on the LED board and cover when connecting the plug.

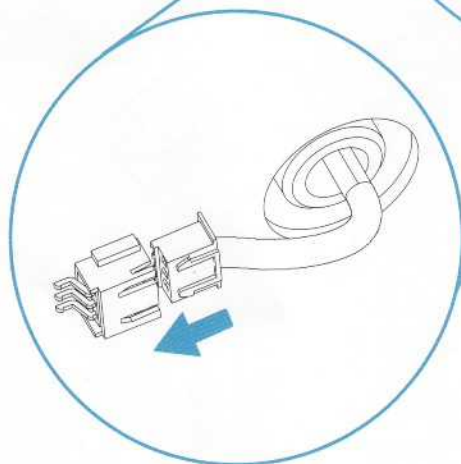

4

Attach the LED board and cover cover using the three screws removed (explained in step 1).

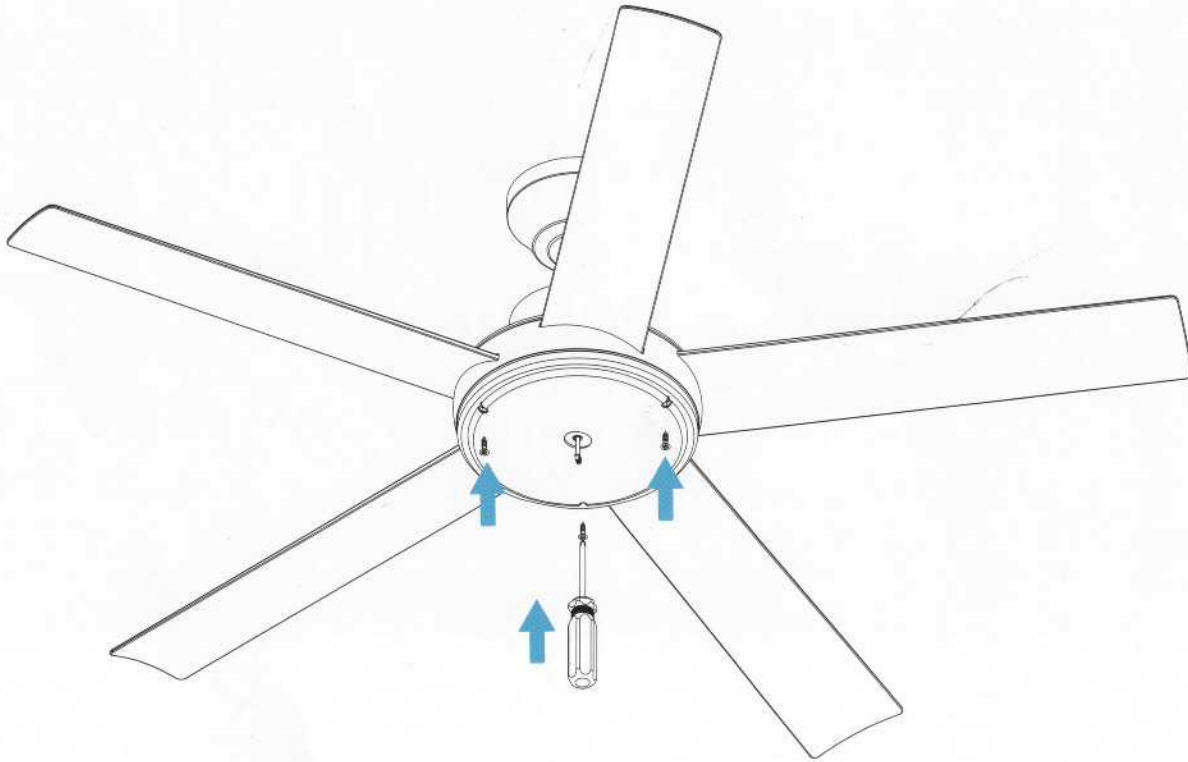

WARNING

Check that LEDs are not crimped by the LED board and cover cover after installed.



8

## INSTALLING THE ACRYLIC SHADE



**PREVENT ACRYLIC FALLING.**  
Make sure that acrylic shade is properly secured.

1

Lift the acrylic shade and align the notches in the acrylic shade with the tabs in the light ring.

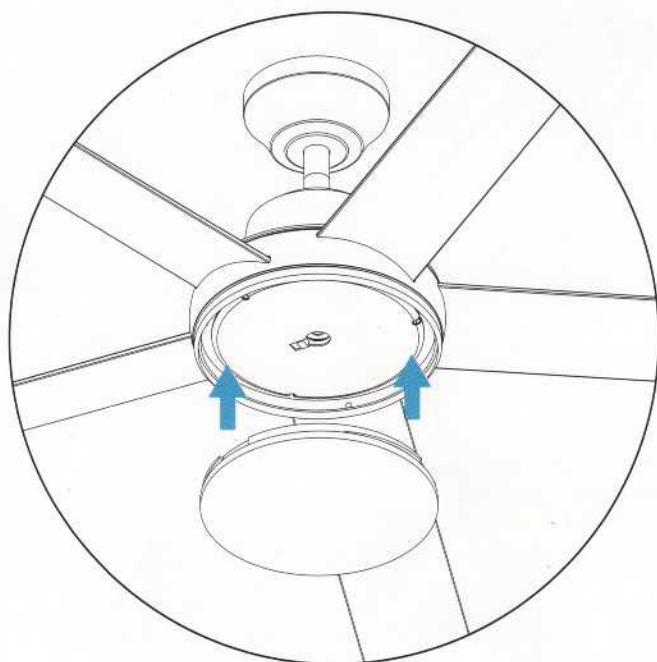

2

Attach the acrylic shade by lifting and turning it clockwise one-third of a full turn until it stops.  
**NOTE: Check to ensure proper engagement.**

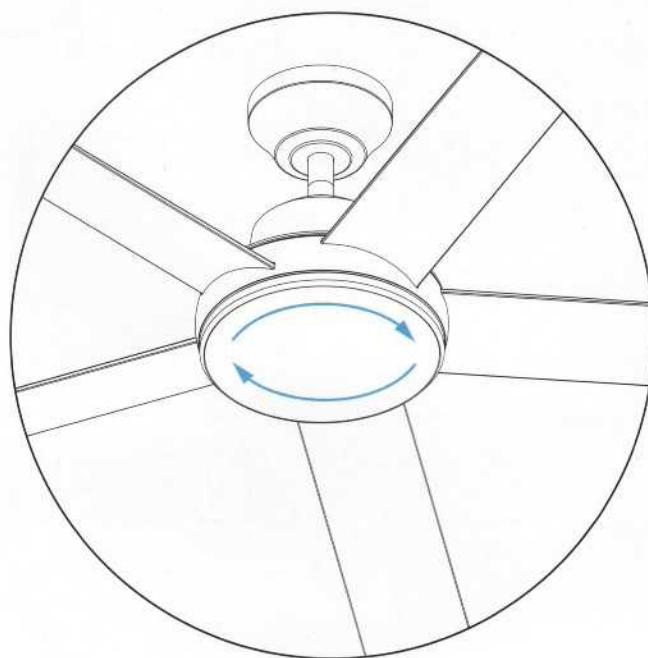

### Having issues attaching the acrylic shade?

Make sure the light ring was installed in the correct position (See page 15).

3

Turn on the circuit breakers to the outlet box associated with the wall switch location, then turn on the wall switch and check if the Atomi Smart WiFi Ceiling Fan has 100% of white light brightness. You can check the brightness using the Atomi Smart app or with the included remote controller.

If it does not have 100% of white light brightness, please check all wiring for any wrong connections.

If it has 100% of white light brightness, please proceed to the next step.

Now that your Smart WiFi Ceiling Fan is installed, it is time to connect and start using it.

# Connecting your Smart WiFi Ceiling Fan

①

Scan the QR code below



or go to <https://atomismart.com/app/>

Get the app

Download the Atom Smart app from the App Store or Google Play.

②

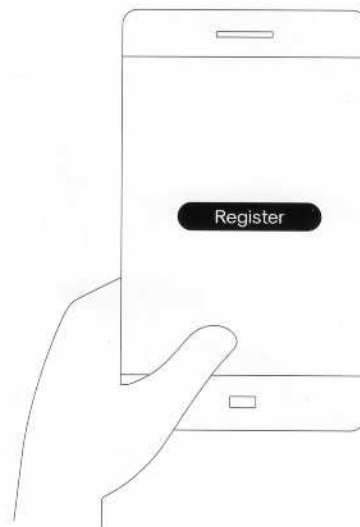

Register

Follow the on-screen instructions and register an account.

Make sure to allow access to Location (Android), Bluetooth® and Local Network (iOS).

③

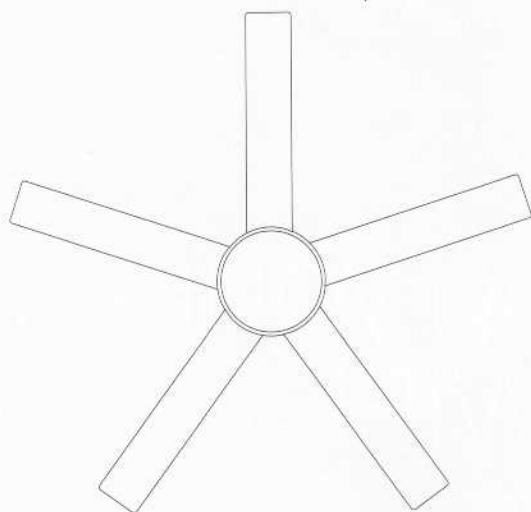

### Turn on your smart device

And long press (5 seconds) the WiFi button on the remote. The fan light will start flashing white.

④

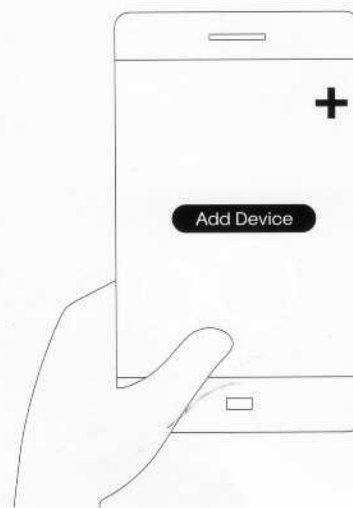

### Add your smart device

Press "Add Device" or the "+" sign and select "Connect Device" on the pop-up that appears.

If the pop-up does not appear, close the app and try again. Still nothing? Read the "Troubleshooting" section on this user guide.

⑤

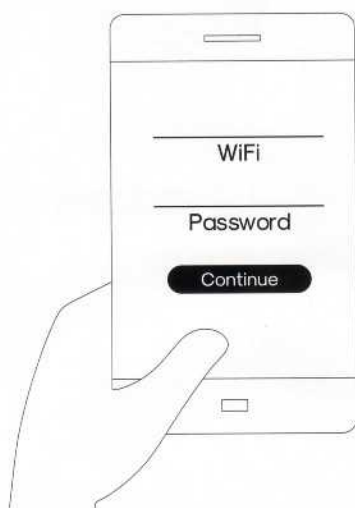

### Connect your 2.4GHz WiFi network\*

Enter or select your local WiFi name, enter your password, then press "Continue".

\*Make sure you're connected to a 2.4GHz WiFi network (Atomi Smart can't connect to 5GHz networks).



BAG  
E1

# USING THE REMOTE CONTROL

## Control buttons

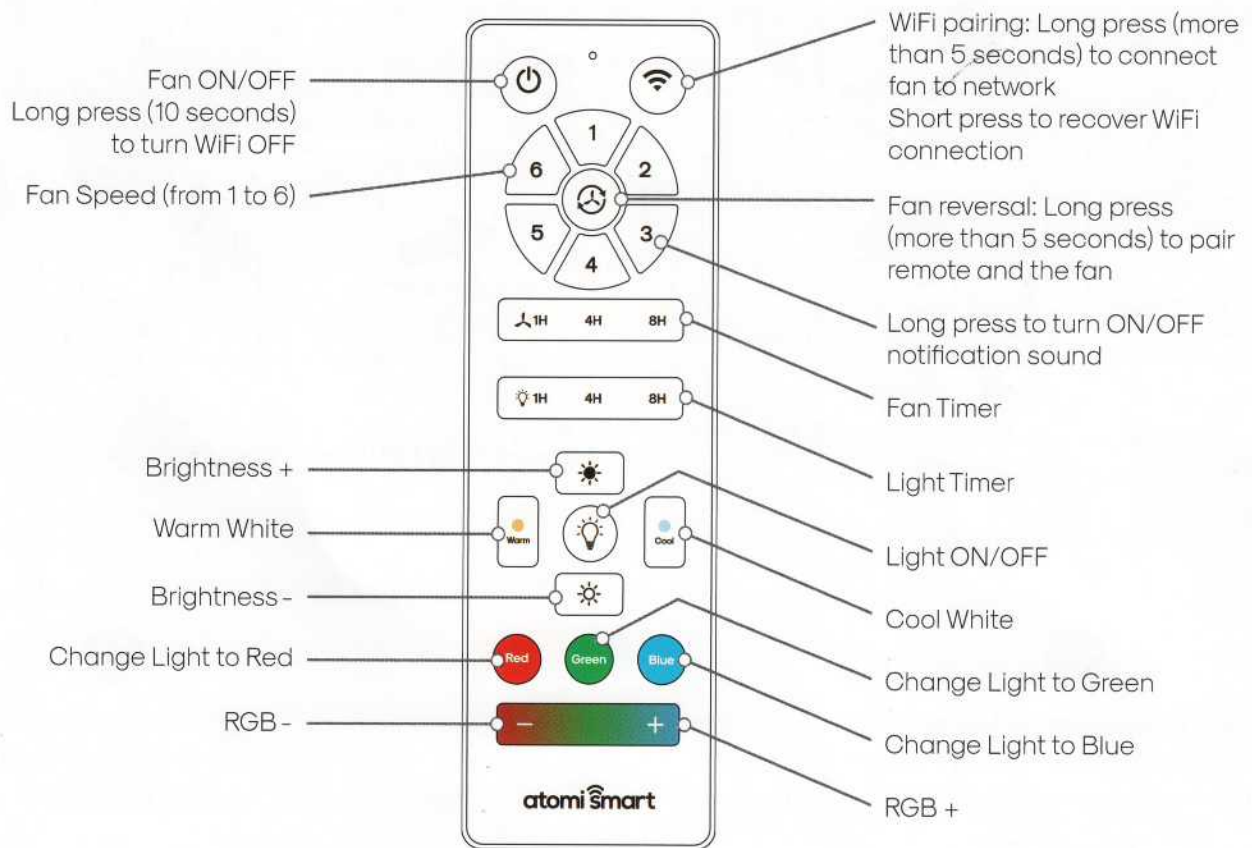

Note: The remote control is not waterproof and requires (2x) AAA batteries (not included).

## Attaching to an existing light switch

Note: This is only compatible with toggle switches.

1

Remove the screws from your light switch cover (Do not remove the cover).

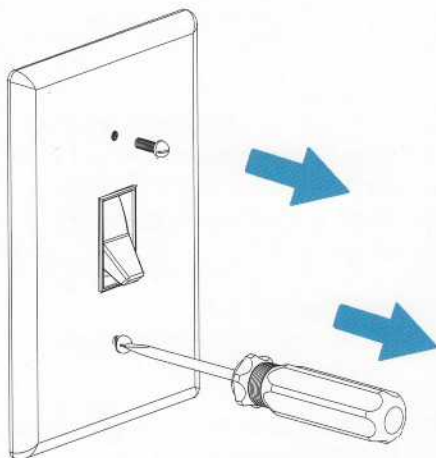

2

Place the remote control mount over the cover and attach it with the cover's screws.

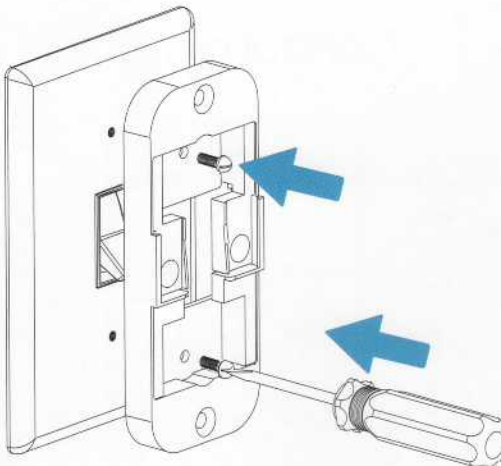

3

Slide the remote control holder in place, then insert the controller.

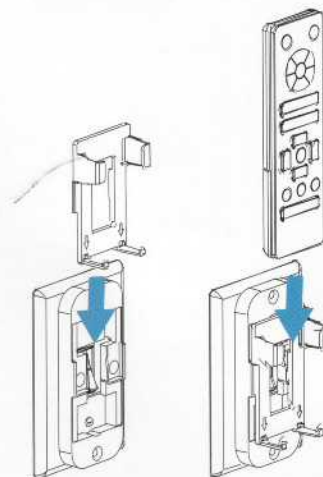

## Mounting it to the wall

22

BAG  
E2

1

Use a pencil to mark the holes on the wall and check for alignment, then drill the holes.

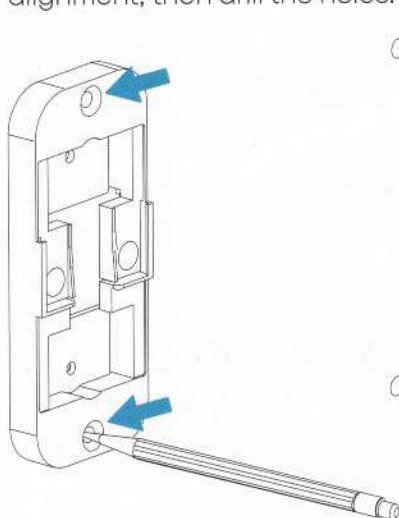

2

Use a screwdriver to screw in the anchors and screws in each hole.

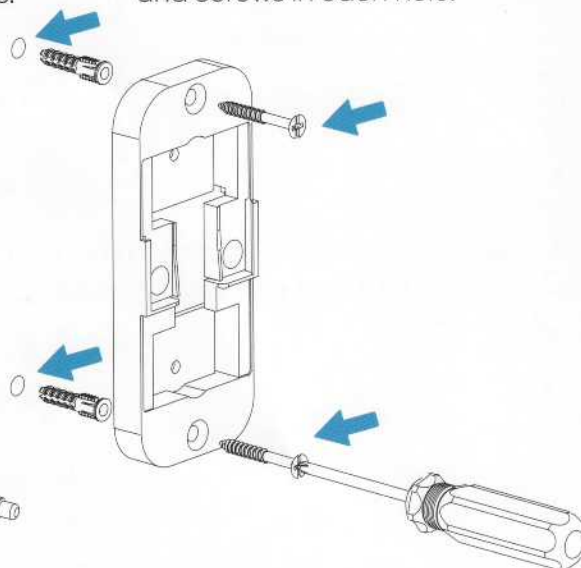

3

Slide the remote control holder in place, then insert the controller.

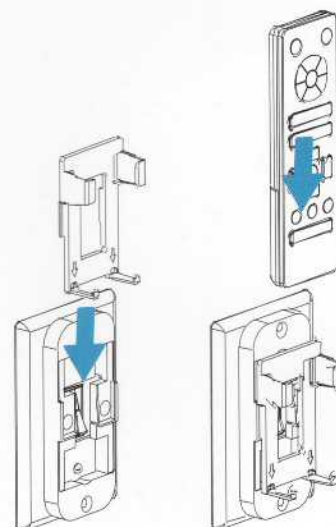

Alternatively, you can use the 3M sticker to fix the bracket on the wall.

## USING THE BALANCE KIT

Follow these steps to properly even out the blade weight distribution.

1

Ensure your fan is correctly installed and all fasteners are secure. It is recommended to run the fan on HIGH for 10-20 seconds to perform these next steps.

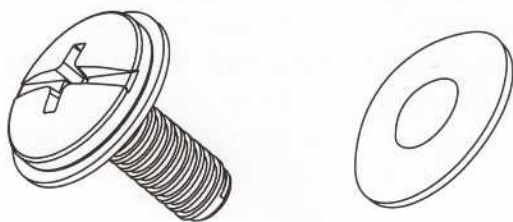

2

Pause your fan to attach the clip to the end of any blade. Run your fan and observe the wobble. Stop the fan and move the clip to the next blade, repeating these steps for all the fan blades.

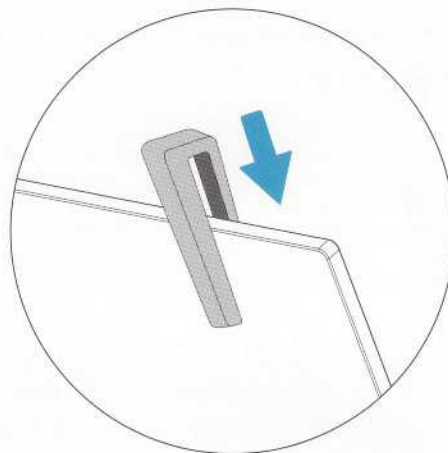

3

Now, move the clip to the blade that caused the least wobble. Run your fan and observe the wobble. Adjust the clip in small increments along the edge of the blade to achieve the least wobble.

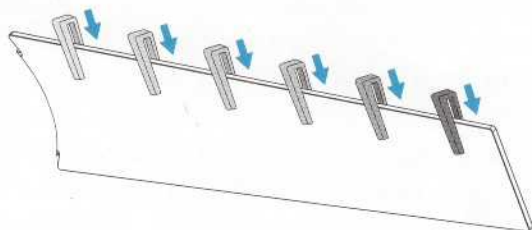

4

At the location where you noticed the least wobble, adhere the balance weight and remove the clip.

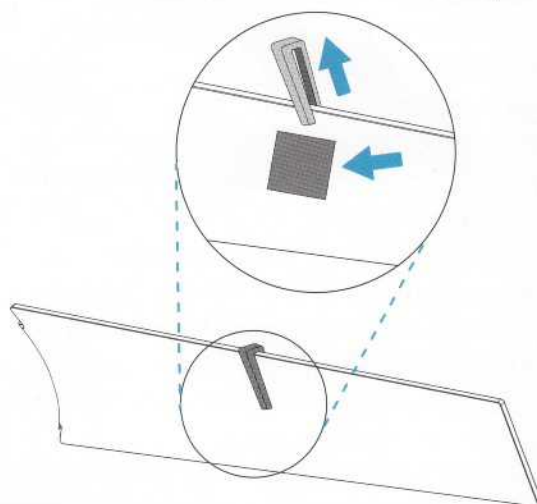

Product is ready to use.



# TROUBLESHOOTING

## The pop-up does not appear when adding a device.

Make sure that you are allowing the app to access your phone's Location (Android), Bluetooth and Local Network (iOS). For more details, visit our website's Support page.

If the pop-up still doesn't appear, follow the steps below:

1. Press "Add Device" or the "+" sign and select your Atomi Smart device.
2. Follow the on-screen instructions (Make sure you connect to a 2.4GHz WiFi Network).

## My WiFi network doesn't appear in the Atomi Smart app.

Use your smartphone to confirm that you have at least two WiFi bars in the vicinity of your Atomi Smart device. If not, move your Atomi Smart device closer to your router. (The list will refresh every 10 seconds).

## Cannot connect to my WiFi network.

Make sure that you have entered the correct WiFi password during the WiFi setup. Check if there are problems with your internet connection. If the WiFi signal is too weak, reset your WiFi router and try again.

## I'm getting "Failed to Add Device", "Failed to find router" or "DHCP" error.

- Confirm that your phone is connected to a 2.4GHz WiFi network.
- Check whether the router password you entered is correct.
- Confirm that the DHCP service is enabled on your router settings.
- Make sure that your WiFi signal is strong.
- Temporarily disable your 5GHz network.
- If you have a mesh network/router that does not allow you to disable 5GHz, try to move farther away from your router until your phone moves to the 2.4GHz band.
- For more Connection Troubleshooting tips, visit [atomismart.com/connection-troubleshooting/](http://atomismart.com/connection-troubleshooting/)

## My Atomi Smart device appears as "Unavailable" or "Offline" in the app.

Refresh the device list.

## I just replaced my router.

If you replace your router, you will need to reset your devices and add them again to the app.

## How to reset my fan's WiFi?

Long press (5 seconds) the WiFi button on the remote control.

## The Ceiling Fan does not work.

- Make sure that the circuit breaker power is turned on.
- Confirm that your wall switch is on.
- Turn off the power from your circuit breaker and check the fan's wiring for any connection issues.

## The Ceiling Fan is too noisy.

Confirm that the blades are properly installed.

## The Ceiling Fan is wobbling.

- Confirm that the downrod was correctly attached to the mounting bracket.
- Make sure that the mounting screws are firmly screwed in.
- Confirm that the canopy is firmly attached to the mounting bracket.
- Note any warped blades. If even one blade is slightly distorted, it can create an imbalance. Check for warping by standing on a secure ladder and looking down the edge of the blade toward the motor. If there's any curvature, the blade is considered warped. Repeat this step for every blade. If they do not appear uneven, confirm that the screws that attach the blades are tightened and secure. Warped blades cannot be balanced.

Use the included balance kit to even out the blade weight distribution. Directions on how to use it can be found on page 23.



### How to access the battery compartment?

- Remove the remote control battery compartment cover located on the back of the remote.
- Insert 2x AAA batteries (not included) into the compartment, making sure they are installed correctly (+) and (-).
- Attach the cover back into place.
- Test the remote control to see if it works by pressing any button. The remote control indicator light should turn on when a button is pressed.

### How to use batteries for the remote control?

- Always purchase the correct size and grade of the battery most suitable for the intended use.
- Replace all batteries of a set at the same time.
- Clean the batteries' contacts and also those of the device prior to battery installation.
- Ensure the batteries are installed correctly with regard of polarity (+ and -).
- Remove batteries from equipment that is not to be used for an extended period of time.
- Remove used batteries promptly.

### Remote Control doesn't work.

- Make sure that the remote was paired to the fan. Please see page 21 for more details.
- Make sure that the 2x AAA batteries (not included) are correctly in place.
- Replace the batteries with new ones.

### How to pair the remote control?

1. Once connected to the app, turn off the wall switch and wait 20-30 seconds.
2. Turn on the wall switch, point the remote control to the ceiling fan, and press and hold the "Fan Reversal" button for 4 seconds. Once the light changes to the warmest white shade, pairing is complete.

NOTE: Please complete this step within 30 seconds from the moment the wall switch is turned on. Otherwise, repeat steps 1 and 2.

3. If you have more than one fan, to avoid interference between fans during the remote pairing process, make sure that only 1 fan is powered on at a time. If you did not see the light change to warm white at step 2, please repeat steps 1 and 2.

For more information about app and device features, tutorials and troubleshooting tips go to:  
[www.atomismart.com/helpCeilingFan](http://www.atomismart.com/helpCeilingFan)

## STILL CAN'T CONNECT? NEED ASSISTANCE?

Our friendly customer service team will work hard to put a smile back on your face. Here's how we can connect.



1-800-757-1440

Mon-Fri 9:00-5:00 EST (U.S.)



or [support@atomiusa.com](mailto:support@atomiusa.com)